



FRP CABLE TRAYS & CABLE LADDER SYSTEMS

A cost-effective alternative for corrosive and chemical environments.



**monaco
distributors**

1300 666 266
www.monacodistributors.com.au

FRP Cable Trays & Ladder Systems



Monaco Distributors FRP Cable Tray & Cable Ladder Systems are a cost-effective alternative to metal solutions in corrosive environments.

With no ongoing maintenance our system is supplied with both FRP and stainless steel fasteners to suit your needs.

The solution includes all the necessary fittings, including: 3-way T sections; 4-way cross-sections; rising internal and external 90 & 45 degree bends; left and right hand horizontal bends; reducers; couplers; and support and anchoring systems.

Our system is also meets the necessary standards for strength (NEMA-FG1-1993) and international fire retardancy standards (ISO9001 accredited).

Cable ladders come up to 1000mm wide. Cable trays come up to 750 mm wide.

Applications

- Offshore oil platforms
- Chemical plants
- Refineries
- Effluent treatment plants
- Food industry
- Pharmaceutical production
- Metallurgical plants
- Marine industry

Advantages

- Corrosion resistant
- Fire retardant
- High strength
- Easy to install
- Lightweight
- U.V. resistant
- More durable than steel

MONACO GRP CABLE LADDERS FOR POWER CABLES

Code	Side Runner (H)	NEMA Load Class	Duty
CL-75-W	75	8A/68	Light Duty
CL-100-W	100	10A/88/6C	Medium Duty
CLh-150-W	150	8C/108	Heavy Duty
CLh-160E-W	160	10C/128/20A	Heavy Duty
CLh-200-W	200	20C	Extra Heavy

Substitute 'W' by width of tray while ordering. *H = Height of cable ladder*

Working Allowable Load (Kg/m)					
Support Span	CL-75-W	CL-100-W	CLh-150-W	CLh-160E-W	CLh-200-W
6m	-	-	-	75	150
4m	-	-	75	110	150
3m	-	75	110	150	-
2.5	75	110	150	150	-
2m	110	150	150	150	-

NEMA Class \blacksquare 6, 8, 10, 12, 20 are support spans in feet.

A=50 lbs/ft (75 kg/m), B=75 lbs/ft (110 kg/m), C=100 lbs/ft (150 kg/m)

MEETS EIL-OED-S-422-REV.4 & NEMA FG1-1993 SPECIFICATIONS

	Standard Product	Alternative Options
Material	Polyester Resin	Vinyl Ester Resin, Phenolic Resin
Fire Retardancy	UL94V1, 8S476 Part 7 and 6 Class II, IS-6746, ASTM-D-635	UL94VO, Class-I
Length	3m	3 - 6 m
Width	150 - 1000mm	Sizes as required
Rung Construction	GRP Square Tubes	GRP Strut-Channel / GRP Rod
Rung Spacing	300 mm	500 mm or as required
Coupler Plates	GRP/FRP with SS Bolts	SS Coupler Plates & Bolts
Radius of Bends	300 mm	600 mm - 900 mm
Angles of Bends	90° & 45°	As required
Electrostatic	Static	Antistatic

⚠ WARNING! Not to be used as a Walkway, Ladder or support for personnel

ACCESSORIES FOR CABLE LADDERS

90° VERTICAL BENDS

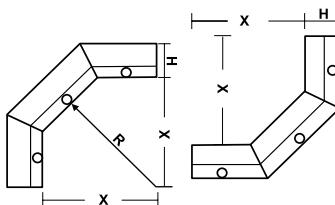

EXTERNAL INTERNAL

Code : CL/CLh-H-W-90°VB-EX/IN-R

		300 R	600 R
CL	X	375	675
CLh	X	405	675

$$L = X + H$$

SAME DIMENSIONS FOR ALL WIDTHS

EQUAL / UNEQUAL TEE

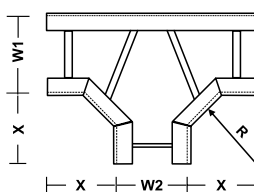

Code : CL/CLh-H-W1-W2-T-R

		300 R	600 R
CL	X	379	679
CLh	X	409	679

$$L1 = X + W1 + 4$$

$$L2 = 2X + W2$$

90° HORIZONTAL BENDS

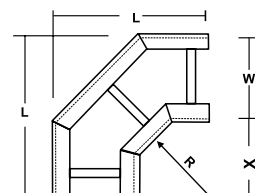

Code : CL/CLh-H-W-90°HB-R

		300 R	600 R
CL	X	379	679
CLh	X	409	679

$$L = X + W + 4$$

EQUAL / UNEQUAL CROSS

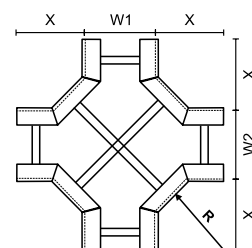

Code : CL/CLh-H-W1-W2-X-R

		300 R	600 R
CL	X	379	679
CLh	X	409	679

$$L1 = 2X + W1$$

$$L2 = 2X + W2$$

LH/RH REDUCER

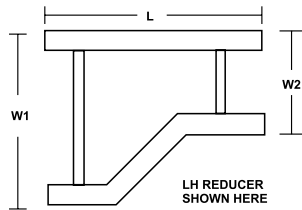

Code : CL-H-W1-W2-LR/RR

W1 \ W2	900	800	750	700	600	500	450	400	300	200	150
800	500	-	-	-	-	-	-	-	-	-	-
750	550	450	-	-	-	-	-	-	-	-	-
700	600	500	450	-	-	-	-	-	-	-	-
600	700	600	550	500	-	-	-	-	-	-	-
500	800	700	650	600	500	-	-	-	-	-	-
450	850	750	700	650	550	450	-	-	-	-	-
400	900	800	750	700	600	500	450	-	-	-	-
300	1000	900	850	800	700	600	550	500	-	-	-
200	1100	1000	950	900	800	700	650	600	500	-	-
150	1150	1050	1000	950	850	750	700	650	550	450	-
100	1200	1100	1050	1000	900	800	750	700	600	500	450

CONCENTRIC REDUCER

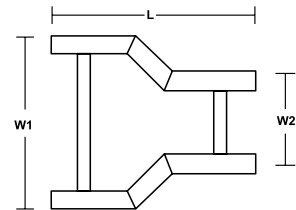

Code : CL-H-W1-W2-CR

W1 \ W2	900	800	750	700	600	500	450	400	300	200	150
800	450	-	-	-	-	-	-	-	-	-	-
750	475	425	-	-	-	-	-	-	-	-	-
700	500	450	425	-	-	-	-	-	-	-	-
600	550	500	475	450	-	-	-	-	-	-	-
500	600	550	525	500	450	-	-	-	-	-	-
450	625	575	550	525	475	425	-	-	-	-	-
400	650	600	575	550	500	450	425	-	-	-	-
300	700	650	625	600	550	500	475	450	-	-	-
200	750	700	675	650	600	550	525	500	450	-	-
150	775	725	700	675	625	575	550	525	475	425	-
100	800	750	725	700	650	600	575	550	500	450	425

Dimensions for 75H & 100H Cable Ladders given in these two tables.
For Dimensions of Reducers of heavy duty Cable Ladders (CLh) add 60mm.

MONACO GRP/FRP PERFORATED CABLE TRAYS



CABLE TRAY U CHANNEL TYPE

Code	Sizes Width	Channel Size W x H
CT - 5025	50	50 x 25
CT - 7527	75	75 x 27
CT - 10030	100	100 x 30
CT - 10040	100	100 x 40
CT - 10050	100	100 x 50
CT - 15030	150	150 x 30
CT - 15040	150	150 x 40
CT - 15050	150	150 x 50
CT - 20050	200	200 x 50
CT - 30050	300	300 x 50



CABLE TRAY RETURN FLANGE TYPE

Code	Sizes Width	Channel Size W x H
CTF - 5025	50	50 x 25
CTF - 5050	50	50 x 50
CTF - 10050	100	100 x 50
CTF - 10080/100110	100	100 x 80/110
CTF - 15050/150110	150	150 x 50/110
CTF - 20050	200	200 x 50
CTF - 20080/200110	200	200 x 80/110
CTF - 30050	300	300 x 50
CTF - 30080/300110	300	300 x 80/110
CTF - 40080	400	400 x 80
CTF - 50080/500110	500	500 x 80/110
CTF - 60080/600110	600	600 x 80/110

Loading: Instrumentation cable trays are meant only for light instrument cables or pneumatic tubing loads. Recommended support span is 1.5 m

SPECIFICATIONS OF STANDARD MONACO FRP INSTRUMENT CABLE TRAYS

	Standard Product	Alternative Options
Material	Polyester Resin	Vinylester Resin
Fire Retardancy	Class II, UL94V1, IS-6746, ASTM-D635	Class - I, UL94V0
Length	3 Metres	2 - 6 Metres
Construction	Perforated Type	Solid Base
Width	50 - 600 mm - Pultruded	as required (Moulded)
Radius of Bends	300 mm	600 mm
Colour	Grey	as desired

*NB: GRP & FRP are two nomenclatures for same fibre glass cable trays and ladders. Tolerance: Tolerance on all dimensions in ± 6 mm.

ACCESSORIES for Perforated Type Instrumentation Cable Tray

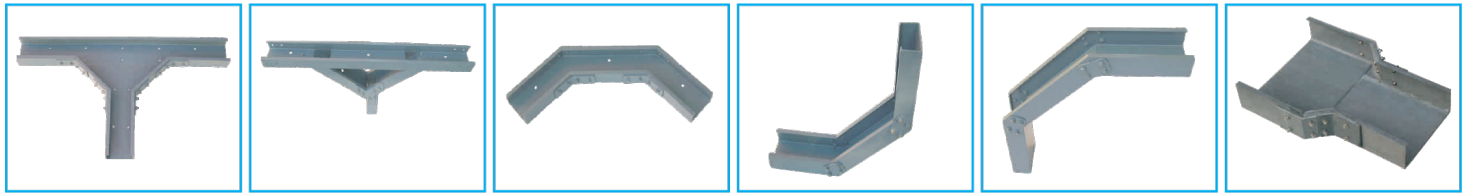

90° TEE

90° VERTICAL TEE

90° HORIZONTAL BEND

90° VERTICAL INTERNAL BEND

90° VERTICAL EXTERNAL BEND

STRAIGHT REDUCER

Loading: Instrumentation cable trays are meant only for light instrument cables or pneumatic tubing loads

OTHER ACCESSORIES FOR POWER & INSTRUMENTATION CABLE TRAYS

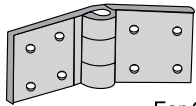

For Cable Ladder
& 80 H Cable Trays

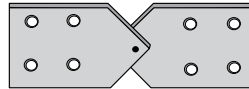

For Cable Ladder
& 80 H Cable Trays

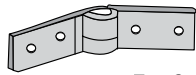

For Cable Trays upto 50H

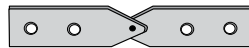

For Cable Trays upto 50H

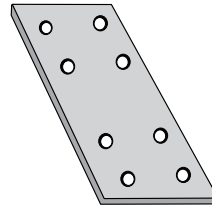

For Cable Ladder
& 80 H Cable Trays

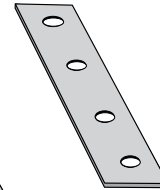

For Cable Trays upto 50H

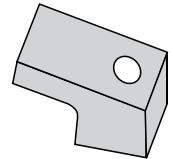

Code : CL/CLh/CT/CTF-H-HH
Horizontal Hinge

Code : CL/CLh/CT/CTF-H-VH
Vertical Hinge

Code : CL/CLh/CT/CTF-H-CP
GRP Coupler

Code : CL/CLh-HD
Hold Down Clamp

GRP SUPPORTS



BR-1-W (for w=50-300)
Light Duty Strut
Bracket Support



BR-2-W (for w=50-300)
Light Duty
Groutable Strut



BR-3-W (for W=50-600)
Medium Duty
Strut Support



BR-4-W (for W=300-1000)
Heavy Duty Strut
Bracket Support



DBR-5-W (for W=300-1000)
Heavy Duty
Double Strut Support



HR-1-W (for w=50-1000)
GRP Stud & Strut
Hanger Support

INSTALLATION INSTRUCTIONS:

REF: NEMA -FG1

Support must be located such that the coupler plates are at the quarter point of the span. For example, if the support span is 3m, the quarter point is 750mm from the support. In a continuous beam configuration, the bending moment in the tray side rail is minimum at points located approximately 1/4 of the span from each tray support. Thus there will be minimum stress on coupler plate if joint is located at 1/4 of span. For bends and other fittings the supports should be within 2 feet of each fitting extremity.

CHEMICAL RESISTANCE:

Isophthalic Polyester Resin

For most of the general applications.

Vinyester Resin

Recommended for severe corrosive atmospheres.

NOTE: *For specific chemical resistance please contact us.*



📍 20 Christie Road, Lonsdale SA 5160

☎ 1300 666 266

🌐 www.monacodistributors.com.au

All illustrations, drawings and descriptive matter in this publication are of a generally informative nature only and do not form part of the specification of the goods. All dimensions shown are Indicative only. Monaco Distributors reserves the right to make, without notice, such modifications in specifications, design, materials or finishes as it deems necessary or desirable. Copyright, patent, intellectual property, photographs and drawings remain the property of Monaco Distributors and must not be reproduced without written permission.

AUTHORISED REPRESENTATIVE: